

**AGENDA
ROSE TOWNSHIP
9080 Mason Street
Holly, MI 48442
August 23, 2022-Special Meeting
11:00 A.M.**



CALL TO ORDER:

ROLL CALL: Dianne Scheib-Snider, Supervisor
Debbie Miller, Clerk
Paul Gambka, Treasurer

Patricia Walls, Trustee
Glen Noble, Trustee

1. Approval of Agenda

2. Brief Public Comments on new business agenda items only, comments only, limit comments to 3 minutes

3. New Business

A. Supervisor is seeking approval to participate with other communities in the opposition of the Oakland County Transit Millage.

4. Brief Public Comments-Comments only, limit comments to 3 minutes

5. Adjournment

This notice is posted in compliance with PA267 of 1976 as amended (Open Meetings Act), MCLA 41.72a (2) (3) and the Americans with Disabilities Act. Individuals with disabilities requiring auxiliary aids or services should contact the Rose Township Board of Trustees by contacting the Rose Township Clerk's office, 9080 Mason Street, Holly, MI 48442 (248) 634-8701 clerk@rosetownship.com.

Dianne Scheib-Snider, Rose Township Supervisor

Oakland County Official Proposal

November 8, 2022

General Election Proposal

Oakland County Authority

Oakland County Public Transportation Millage

A proposal to authorize Oakland County to levy a millage for the purpose of funding public transportation services in Oakland County, including operating, maintaining, improving, and expanding transit services, creating and expanding new fixed routes for bus service connecting local communities, expanding transportation services for seniors, veterans, and people with disabilities, and providing transportation to get employees to jobs, patients to healthcare, students to colleges and universities, for the general public to have more transportation options, and for related purposes authorized by law.

This millage would be levied at a maximum rate of .95 mills (95 cents per \$1,000 in taxable value) for a period of 10 years beginning in 2022 and ending in 2031.

This millage would replace an expiring millage levied by the Oakland County Public Transportation Authority supporting the Suburban Mobility Authority for Regional Transportation (SMART), and fund replacement of other local public transportation millages.

If this new millage is approved and levied, revenue will be distributed to Oakland County, SMART, North Oakland Transportation Authority (NOTA), Older Persons' Commission (OPC), and the Western Oakland Transportation Authority (WOTA). It is estimated that \$66,163,000 will be collected in the first year. Expenditure of revenue from the millage will be subject to oversight by the Oakland County Board of Commissioners and to independent audits.

Should this proposal be adopted?

<u>CVT</u>	<u>2022 TAXABLE VALUE</u>	<u>0.95</u>	
Brandon Twp	611,592,260	0.95	581,012.65
Village of Ortonville	44,054,830	0.95	<u>41,852.09</u>
Brandon Twp & Village	655,647,090	0.95	622,864.74
Commerce Twp	2,271,193,120	0.95	2,157,633.46
Village of Wolverine Lake	206,165,020	0.95	<u>195,856.77</u>
Commerce Twp & Village	2,477,358,140	0.95	2,353,490.23
Groveland Twp	264,010,840	0.95	250,810.30
Highland Twp	946,664,370	0.95	899,331.15
Holly Twp	265,150,710	0.95	251,893.17
Village of Holly	139,638,360	0.95	<u>132,656.44</u>
Holly Twp & Village	404,789,070	0.95	384,549.62
Independence Twp	1,938,445,369	0.95	1,841,523.10
Lyon Twp	1,568,593,600	0.95	1,490,163.92
Milford Twp	784,847,860	0.95	745,605.47
Village of Milford	333,693,580	0.95	<u>317,008.90</u>
Milford Twp & Village	1,118,541,440	0.95	1,062,614.37
Rose Twp	326,915,170	0.95	310,569.41
Springfield Twp	773,010,010	0.95	734,359.51
South Lyon	448,557,530	0.95	426,129.65
Wixom	885,813,100	0.95	841,522.45

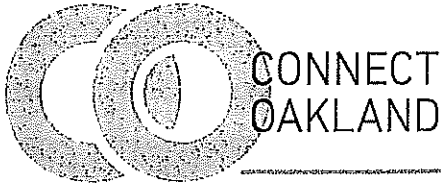

ConnectOakland is a proposed ten-year, 0.95 mill community transit initiative.

ConnectOakland would be administered by Oakland County. It would extend transit options across the county. Proceeds from the measure would go to existing transit providers. The funding would also enable new access to healthcare, education, employment, and shopping destinations beyond the reach of current transit service.

ConnectOakland would support a variety of community-oriented transit services, including:

 Paratransit	 Microtransit	 Fixed Route
<p>Reservation-based service for essential trips, such as medical appointments and grocery shopping. Paratransit promotes independence for seniors and persons with disabilities.</p>	<p>Small vehicles providing flexible, on-demand service open to all. Requested through a mobile app or a phone call, microtransit links lower-density suburban areas into the full transit system.</p>	<p>Regularly scheduled service on major corridors connecting key locations. Fixed-route is fast and efficient for longer trips; it's practical in denser areas with sidewalks and mixed land uses.</p>

Goals of ConnectOakland:

- **Replace** three existing millages with one funding measure.
- **Build** on the success of local transit providers.
- **Fill** the holes and eliminate the gaps in transit access.
- **Establish** a basic level of transit service throughout Oakland County.
- **Leverage** new technologies for modern, efficient transit.
- **Focus** on access to everyday destinations and vital resources.
- **Increase** awareness of transit options for residents and businesses.

The Oakland County Public Transit Millage

Summary

Should the voters in Oakland County approve .95 mills for Oakland County Public Transportation this November, several efforts will be put in place to benefit residents and local communities in Oakland County. These include:

1. **Keep and maintain current public transit** service in place across Oakland County
2. **Improve and expand transit** by creating and extending routes, and expanding rural transit to improve mobility across all of Oakland County
3. **Fund capital improvements** and seize new opportunities to match federal, state, and other funding opportunities as a result of the recently adopted Infrastructure Investment and Jobs Act

The 10-year millage on the November 2022 ballot is estimated to generate \$66,163,000 in the first year.

Millage Breakdown

Keep and maintain current public transit service across Oakland County	\$38.2 M
Improve and expand suburban and rural transit service	\$20.1 M
Capital Improvements	\$7.0 M
Administration by County	\$0.8 M
TOTAL	\$66.1 M

Details

1. Keep and maintain current public transportation services at current levels.

Suburban Mobility Authority for Regional Transportation (SMART) current service	\$33.2 M
North Oakland Transit Authority (NOTA)	\$2.0M
Western Oakland Transit Authority (WOTA)	\$2.0M
Older Persons Commission (OPC)	\$1 M
TOTAL:	\$38.2 M

2. Improve and expand transit across Oakland County

Oakland County Transportation Millage builds on the success of existing transit and provides funding for new routes, paratransit, and microtransit service across county.

New Paratransit Coverage	\$3.2 M
New Microtransit Areas	\$3.5 M
New Routes to High-Demand Areas	\$12.1 M
Service Improvements on Existing Routes	\$1.3 M

TOTAL: \$20.1M

All transit entities in Oakland County are eligible to operate any type of new service, as determined by geography, continuity and capacity.

Potential New Routes

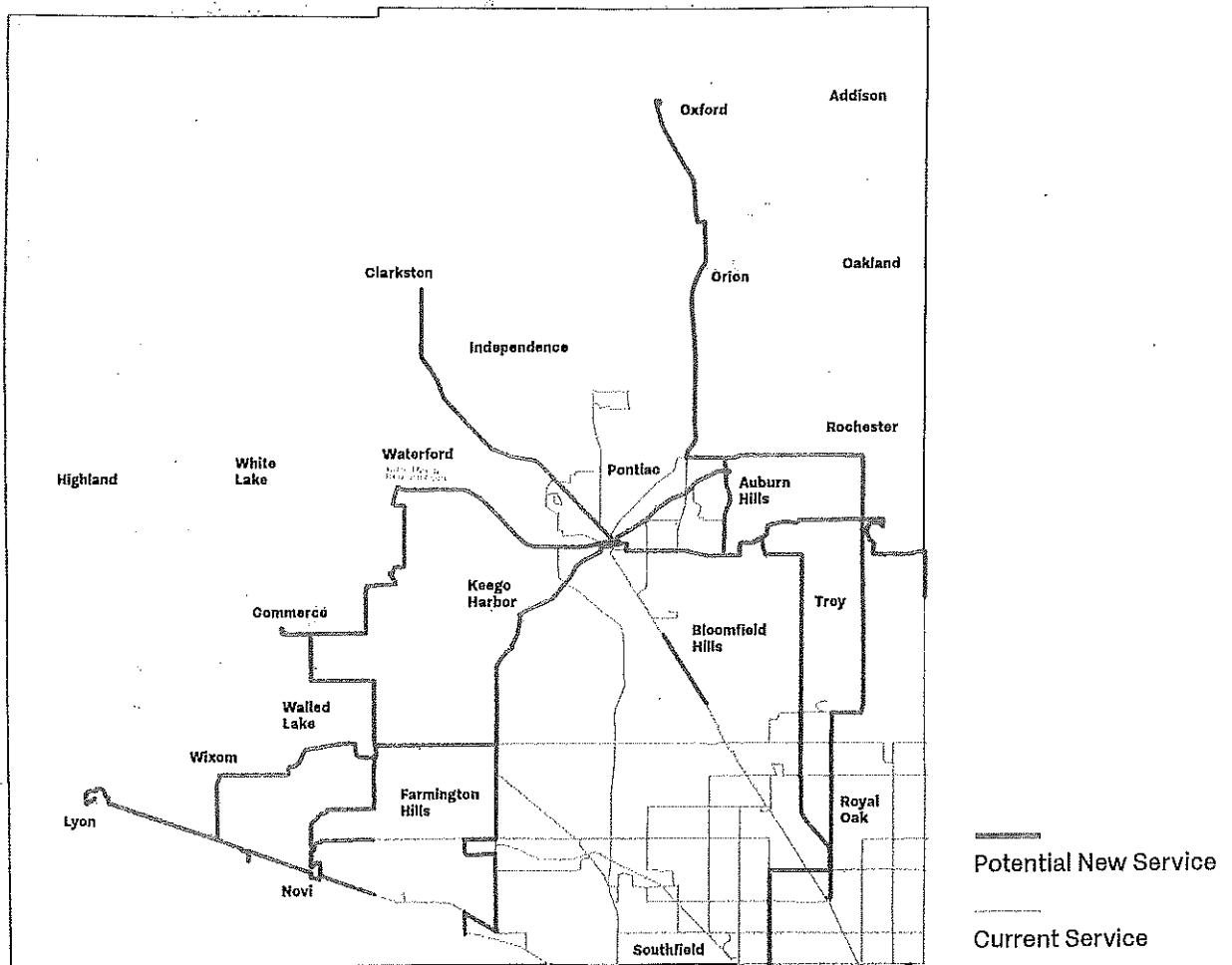

Potential Microtransit Areas

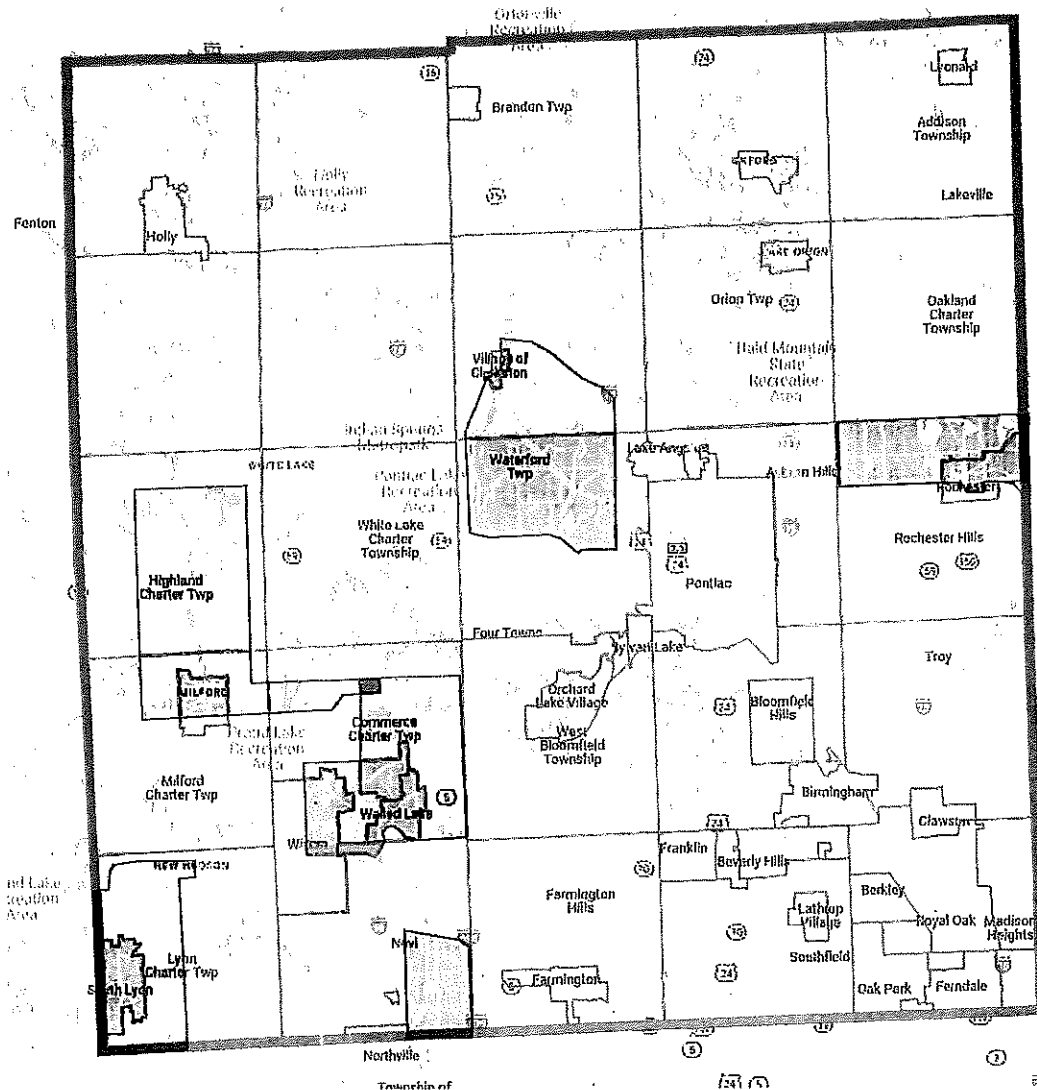

3. Fund capital improvement to support Oakland County Public Transportation

Capital investments will be needed to maintain and expand transit across Oakland County. Over the next five years, Michigan is in line to receive \$308 million over the previous five-year period in public transit funding due to the adoption of the federal bipartisan infrastructure law, also known as the Infrastructure Investment and Jobs Act. To access these new federal resources, local match funding will be required.

Locally funded Infrastructure improvements	\$2 M
Local Match for Other Capital Projects	\$5 M
TOTAL:	\$7M

Conclusions

- The Oakland County Public Transit Millage keeps and maintains the current transit services available in Oakland County
- The millage provides new funding to improve access to transit services across all of Oakland County
- Millage proceeds can be used to access matching funds to support operation and capital costs for Oakland County transit services
- New funds provide an opportunity to improve mobility for seniors, people with disabilities, those without ready access to a car, and those seeking options beyond driving. It helps connect employees to jobs, patients to health care, students to colleges and universities, and the general public to everyday destinations.